



**KEY:**

 DENOTES EXTENT OF PROPOSED ONE WAY

 DENOTES EXTENT OF PART TIME 20MPH LIMIT OPERATING DURING SCHOOL TIMES USING DUAL ACTIVATED WIG WAG VEHICLE ACTIVATED SIGNS DISPLAYING SCHOOL WARNING SIGN AND 20 ROUNDEL TO BE PROVIDED EITHER END OF LIMIT

DYL REFERS TO DOUBLE YELLOW LINES

**NOTE:**  
ALL FEATURES ARE SHOWN AS INDICATIVE LOCATIONS AND WILL BE SUBJECT TO DETAILED DESIGN

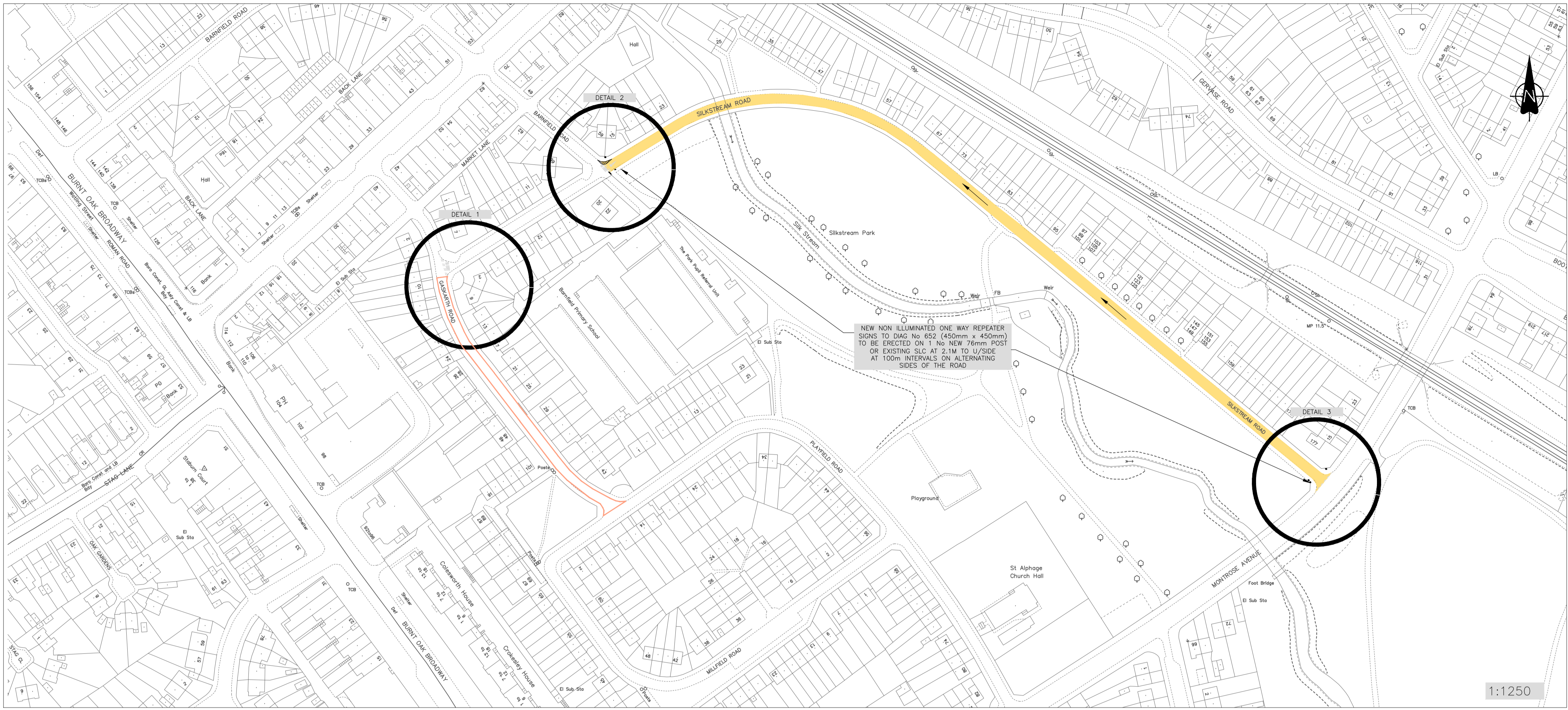

1:1250

**HEALTH, SAFETY & ENVIRONMENTAL INFORMATION**

**NOTE:**  
IT IS ASSUMED THAT THE WORKS WILL BE UNDERTAKEN BY A COMPETENT CONTRACTOR, WHO IS AWARE OF ALL GENERIC RISKS ASSOCIATED WITH THE WORKS. LISTED BELOW ARE 'SIGNIFICANT' RISKS RELATING TO THE WORKS.

If no significant risks have been identified, delete this text and enter 'NONE IDENTIFIED' here.

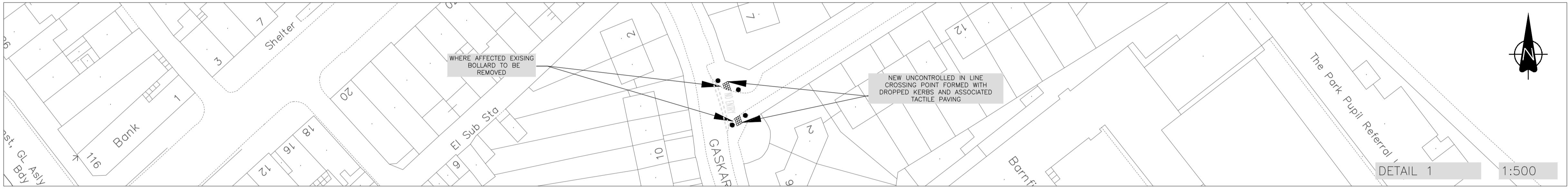

DETAIL 1 1:500

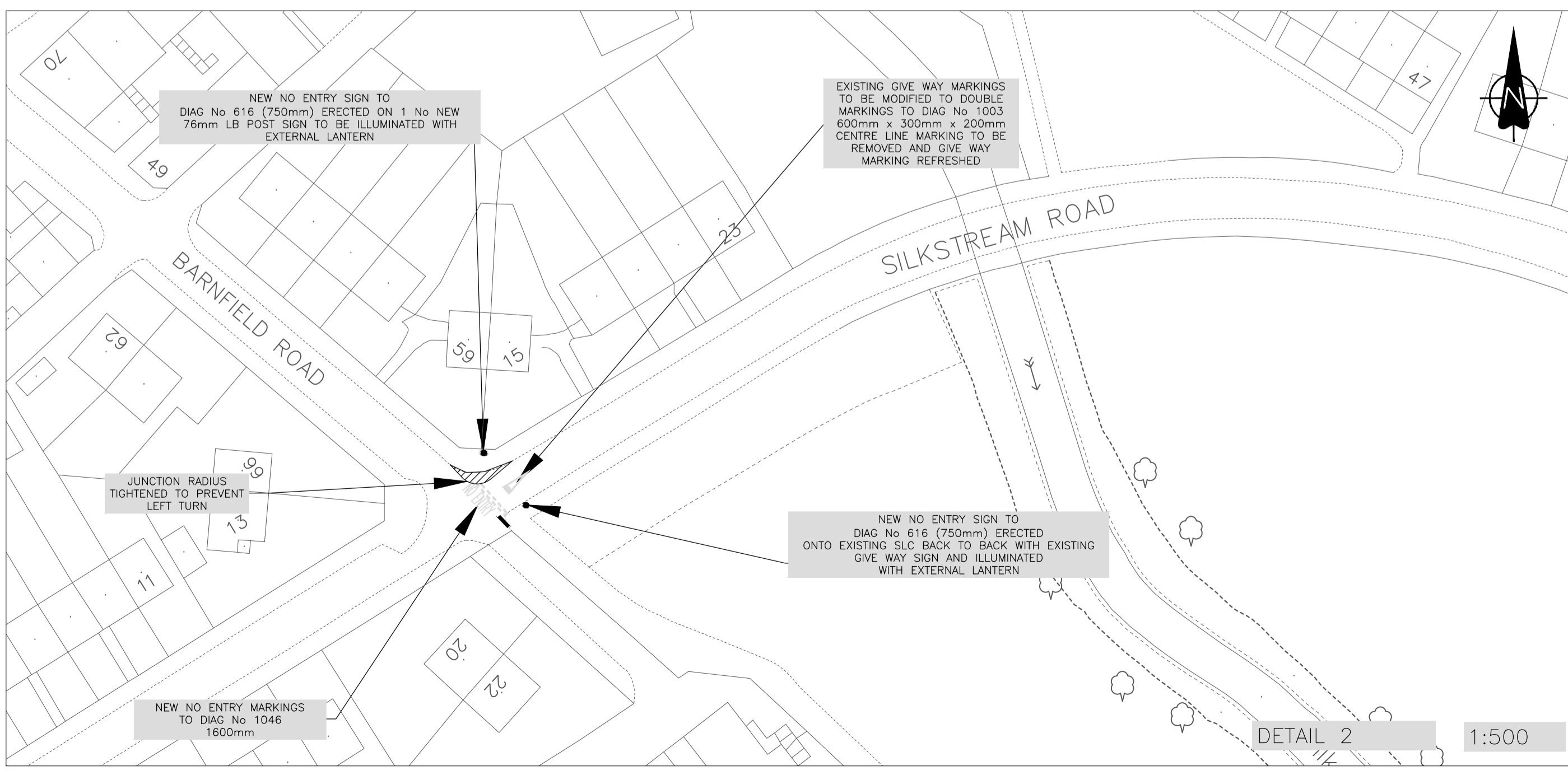

DETAIL 2 1:500

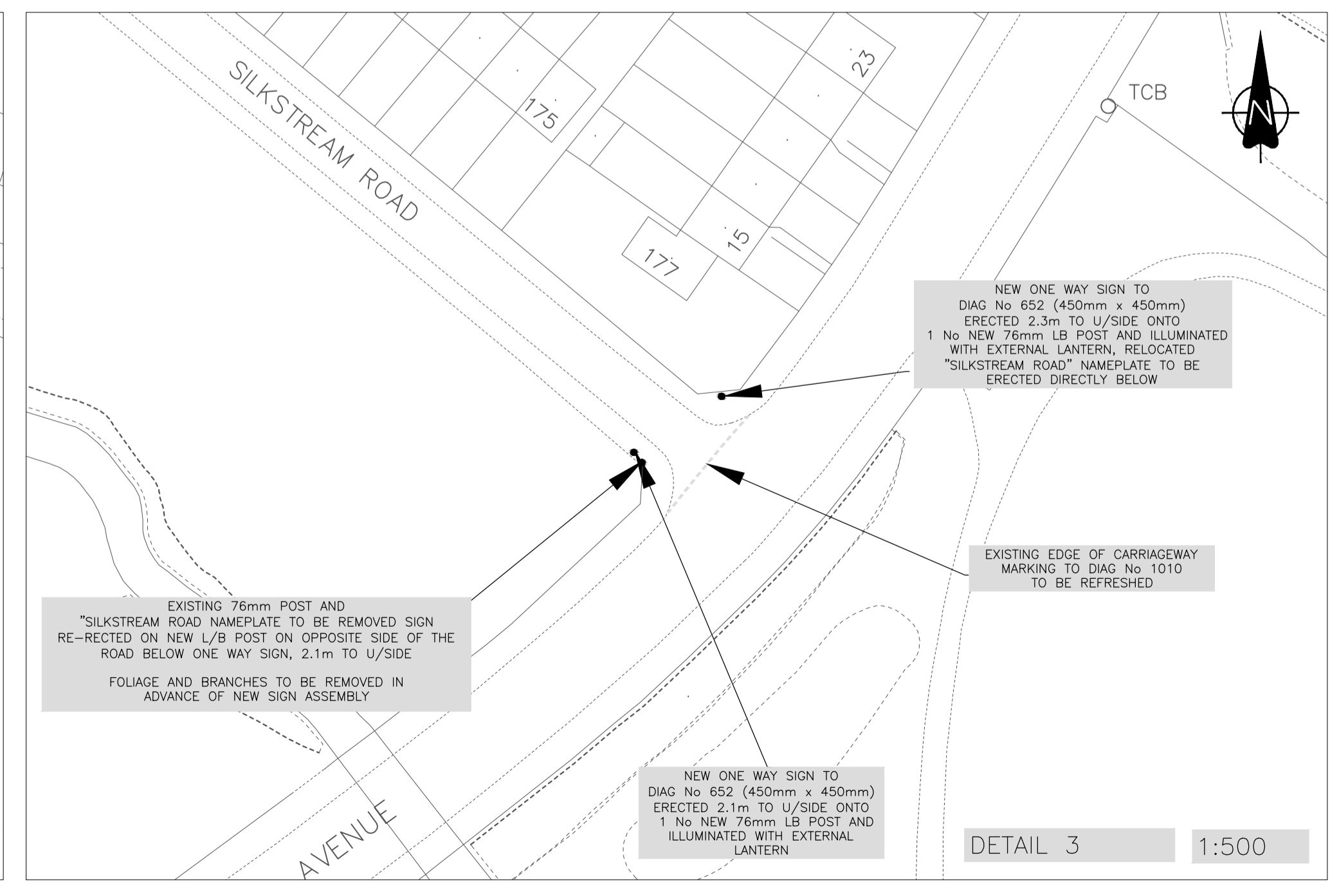

DETAIL 3 1:500

A	AMENDMENTS FOLLOWING ROAD SAFETY AUDIT	HK	KE	OCT 2014
ISSUE	AMENDMENTS	DRAWN	CHECKED	DATE
CLIENT				



**PROJECT**  
TRAFFIC MANAGEMENT AND ACCIDENT REDUCTION (LIP 2014/15)

**TITLE**  
SILKSTREAM ROAD PRELIMINARY DESIGN OPTION 1

**PURPOSE**  
INFORMATION



St Davids House, Pascal Close, St Mellons, Cardiff, CF3 0LW  
T: 02920 803500 W: www.capita.co.uk/infrastructure  
Capita Property and Infrastructure Ltd.

DRAWN	HK	DATE	SEPT 2014	SCALE	AS SHOWN
CHECKED	KE	DATE	SEPT 2014	PROJECT No.	CS/75844
DRG. No.	CS/75844/02/OPTION 1			REVISION REF.	A